

AP MORGAN



Carnforth Road, Harwood Park, Bromsgrove
Offers in the region of £320,000

Features:

- Extended semi-detached house
- Close to sought after schooling
- Three bedrooms
- Open plan sitting/dining room
- Kitchen
- Family shower room
- Rear garden
- Garage & driveway

Description:

Situated within a highly sought-after cul-de-sac location of Harwood Park being within a few hundred feet of the well-regarded Finstall First School, is this extended three-bedroom, semi-detached family home.

The property is approached via a low-maintenance and recently laid gravel driveway with a well-maintained lawn, a garage with fitted electrical sockets and lighting, and an enclosed double-glazed porch that leads to the front door.

Once inside, the property is briefly laid out as follows: an entrance hallway, kitchen, extended open-plan lounge/diner, first-floor landing, double bedrooms one and two, a good-sized bedroom three, and a family shower room.

Well-situated near Aston Fields, the property is within proximity to local bus routes and Bromsgrove Train Station, allowing easy access to central Birmingham and Worcester. Bromsgrove town is located within one mile and offers a good range of high street shops, supermarkets, well-regarded local schools, and good commuter links via the A38, M5, and M42.



Details:

Porch 6'4" x 3' (1.93m x 0.91m)

Hallway

Kitchen 11'9" x 6'9" (3.58m x 2.06m)

Sitting/Dining Room 16'9" (5.1) x 17'10" (5.44) both max

Garage 15'7" x 8'2" (4.75m x 2.5m)

First Floor Landing

Bedroom One 13'10" x 8'8" (4.22m x 2.64m)

Bedroom Two 10'5" x 9'2" (3.18m x 2.8m)

Bedroom Three 8'9" x 8'8" (2.67m x 2.64m)

Shower Room 5'10" x 6'2" (1.78m x 1.88m)



EPC Rating: D

Council Tax Band: C (tbc by solicitors).

Tenure: Freehold (tbc by solicitors).

For more information or to arrange a viewing, please call us on 01527 910 300.

How can we help you?

Need a mortgage?

We recommend Wiser Mortgage Advice. They will search the market for you to ensure you get the right lender and mortgage deal. They typically achieve mortgage offers much more quickly than if you were dealing with lenders directly. The initial appointment is free and without obligation. Call us on 01527 910 300, or visit their website for more information: www.wisermortgageadvice.co.uk

Property to sell?

If you need to sell a property in order to buy, you ideally need to be on the market at least (and preferably Sold STC) before viewing, otherwise you may lose out to other buyers when the right property comes along. In these circumstances we can get your property 'live' quickly. Just book a free valuation and we will visit your property and discuss your needs.

Need a solicitor?

A good solicitor can save you literally weeks of time in the buying/selling process, reducing the stress levels of all involved. We will instruct a reputable firm that is competitive on cost and very reliable. Just ask for a quote.

Need a removal company and storage?

A professional removal company takes the stress out of moving, knowing that your belongings are safe and insured far outweighs any small savings by trying to do it yourself or using a man-and-a-van service. We work closely with and recommend Cube Removals as the leading local firm. For peace of mind and a reliable service call them on 0800 193 0000 or visit their website, cuberemovals.co.uk, to arrange a survey.

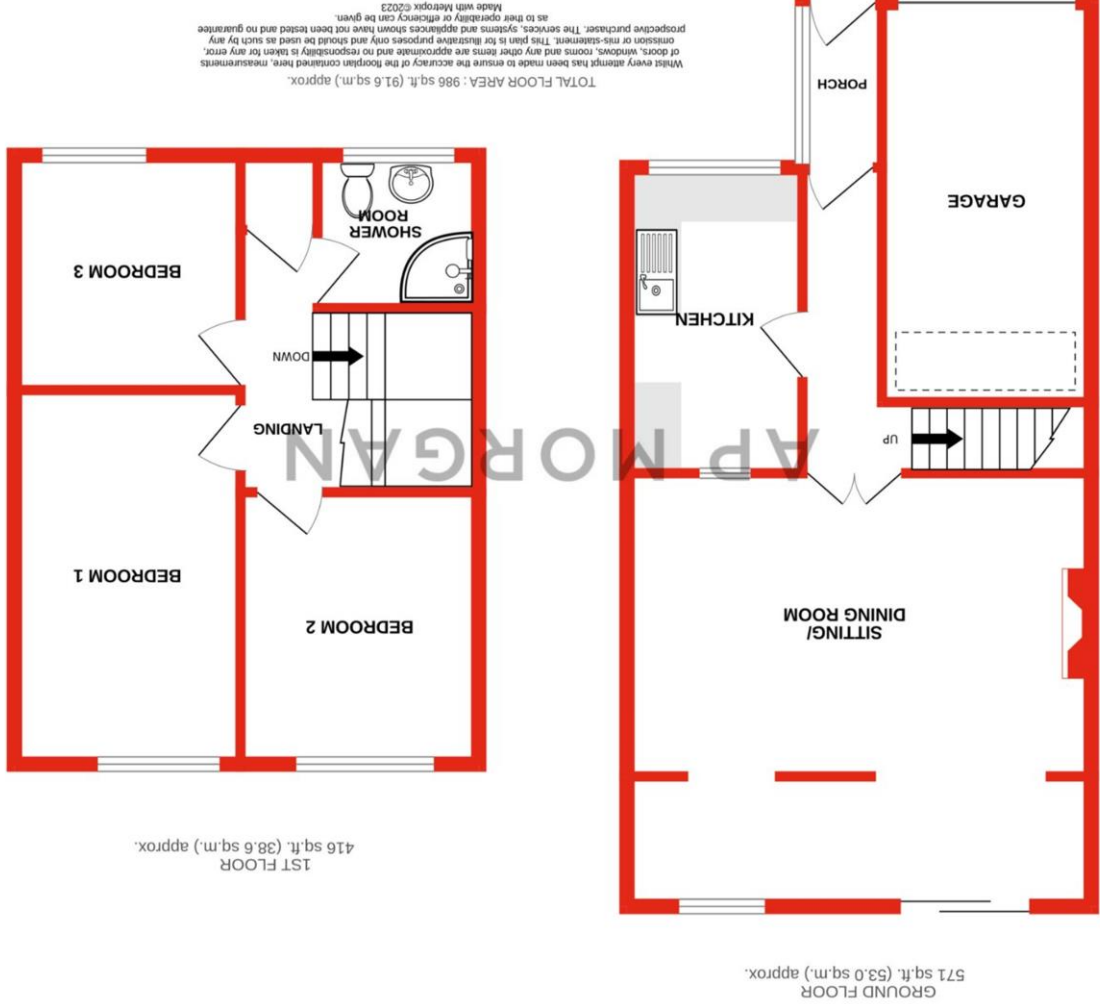

No statement in these details is to be relied upon as representation of fact, and purchasers should satisfy themselves by inspection or otherwise as to the accuracy of the statements contained within. These details do not constitute any part of any offer or contract. AP Morgan and their employees and agents do not have any authority to give any warranty or representation whatsoever in respect of this property. These details and all statements herein are provided without any responsibility on the part of AP Morgan or the vendors. Equipment: AP Morgan has not tested the equipment or central heating system mentioned in these particulars and the purchasers are advised to satisfy themselves as to the working order and condition. Measurements: Great care is taken when measuring, but measurements should not be relied upon for ordering carpets, equipment, etc. The Laws of Copyright protect this material. AP Morgan is the Owner of the copyright. This property sheet forms part of our database and is protected by the database right and copyright laws. No unauthorised copying or distribution without permission.